

Dimension:
Unit=mm

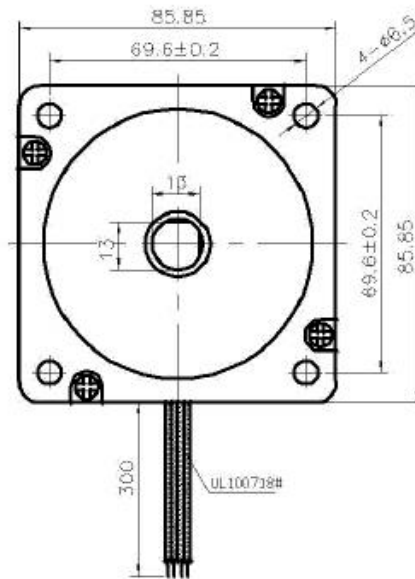

Wiring Diagram:

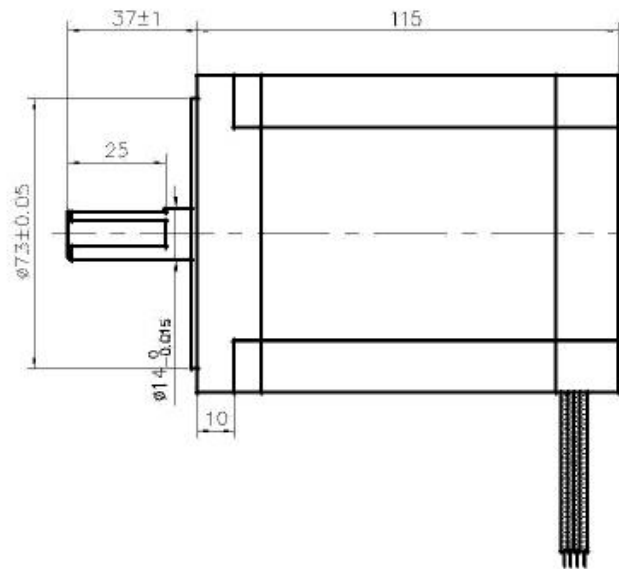
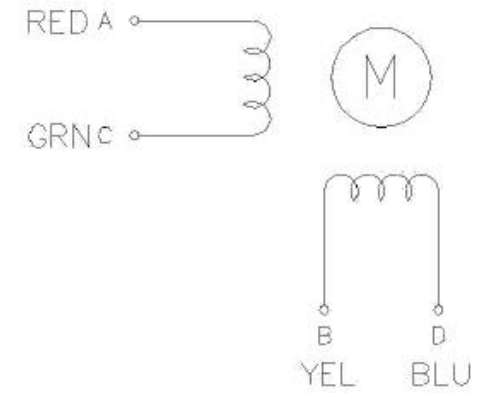

Phase	2		Comment
Step Angle	1.8	deg.	
Voltage	3.0	V	
Current	6.0	A	
Resistance	0.5	ohm	
Inductance	6.0	mH	
Holding Torque	88	kg.cm	
Insulation Class	B		
Mass	3.8	kg	

					Title:			
					Specification			
REV.	QTY.	No.	SIG.	DATE	CLS.MAK	WEIGHT	SCALE	 <small>AUTOMATIZACIÓN Y ROBÓTICA</small>
DESIGN			STD.					
CHECK								
PROC.			APPR.		PAGE:	OF PAGES		